

How to Add a Single Page in WebCT 4

This page will tell you how to add a Single page into your WebCT 4.

Step 1:

First step is to log into WebCT, then you want to click on “Add Page or Tool”.

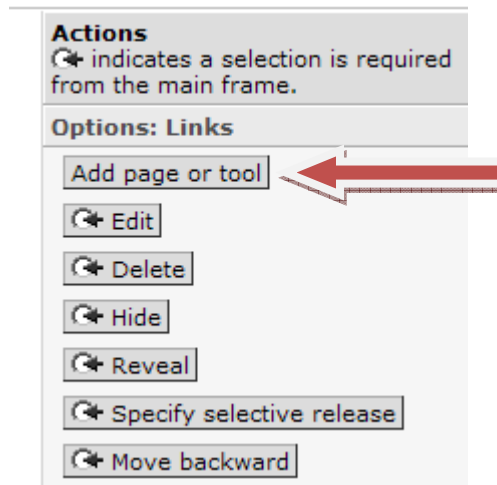

Step 2:

Click on Single page

Add Page or Tool

Select a page or tool to add to your course.

Pages	Course Content Tools
Organizer Page	Syllabus
Single Page 	Content Module
URL	Glossary
	Image Database
	Index
	Content Utilities
	Search
	Compile
	Resume Course
	CD-ROM

Step 3:

Enter the title for the Single Page. Enter the location of the Single Page that you want to display. Decide if you want it to open in a new window. Select where the Page is to show up. Click "Add" to complete the addition.

Add Single Page

1. Enter a title for this item:
2. Enter the information for the Single Page.
Page filename:
Open in: New browser window Same browser window
 Show navigation buttons
3. Decide where to show the link to this item.
 On the *Course Menu*, visible on all pages. Link will appear as text.
 On an *Organizer Page*:
 Link shows item title
 Link shows icon (select below)
 Use default icon
 Use custom icon
Choose icon:
4. Add this item to your course.

