

# How to Add the Self Test Tool in WebCT 4

This page will tell you how to add the Self Test Tool into your WebCT 4.

## Step 1:

First step is to log into WebCT, then you want to click on “Add Page or Tool”.

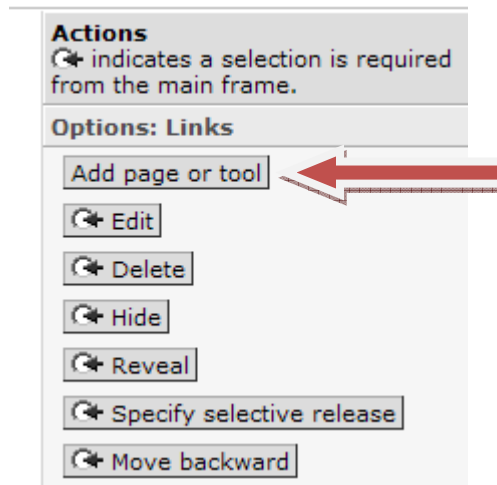

## Step 2:



Click on Self Test

| Communication Tools | Evaluation & Activity Tools   |
|---------------------|---|
| Discussions         | Quizzes/Surveys   |
| Mail                | Self Test  |
| Chat                | Assignments   |
| Whiteboard          | Student Presentations   |
| Calendar            | Student Homepages   |
| Student Tips        |   |

## Step 3:

Enter the title for the Self Test. Select where the tool is to show up. Click “Add” to complete the addition.

### Add Self Test

1. Enter a title for this item:  
2. Decide where to show the link to this item.
  - On the *Course Menu*, visible on all pages. Link will appear as text.
  -   On an *Organizer Page*:  
    - Link shows item title
    - Link shows icon (select below)
      - Use default icon
      - Use custom icon

Choose icon:
3. Add this item to your course.

---

