

How to Add the Image Database Tool in WebCT 4

This page will tell you how to add the Image Database tool into your WebCT 4.

Step 1:

First step is to log into WebCT, then you want to click on “Add Page or Tool”.

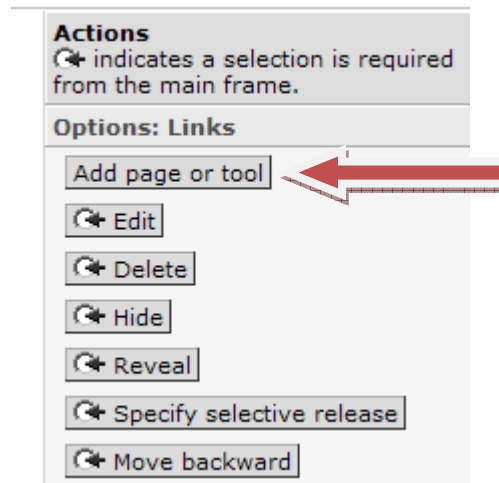

Step 2:

Click on Image Database

Add Page or Tool

Select a page or tool to add to your course.

Pages	Course Content Tools
Capture Image	Syllabus
Print Screen	Content Module
Organizer Page	Glossary
Single Page	Image Database ←
URL	Index
	Content Utilities
	Search
	Compile
	Resume Course
	CD-ROM

Step 3:

Enter the title for the Image Database. Select where the tool is to show up. Click “Add” to complete the addition.

Add Image Database

1. Enter a title for this item: ←
2. Decide where to show the link to this item.
 - On the *Course Menu*, visible on all pages. Link will appear as text.
 - On an *Organizer Page*: ▾
 - Link shows item title
 - Link shows icon (select below)
 - Use default icon
 - Use custom icon

Choose icon:

3. Add this item to your course.

