

# How to Add the Student Presentations Tool in WebCT 4

This page will tell you how to add the Student Presentations Tool into your WebCT 4.

## Step 1:

First step is to log into WebCT, then you want to click on “Add Page or Tool”.

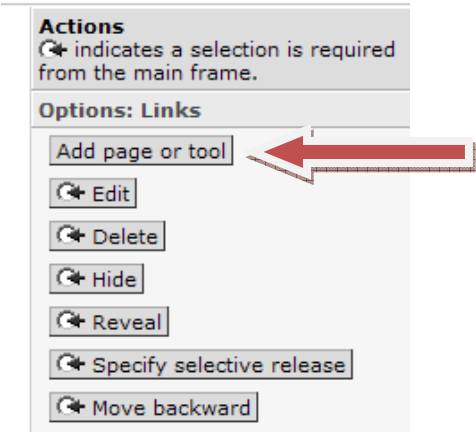

## Step 2:



Click on Student Presentations

Communication Tools	Evaluation & Activity Tools
Discussions	Quizzes/Surveys
Mail	Self Test
Chat	Assignments
Whiteboard	Student Presentations 
Calendar	Student Homepages
Student Tips	

## Step 3:

Enter the title for the Presentations. Select where the tool is to show up. Click “Add” to complete the addition.

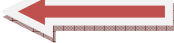
### Add Presentations

1. Enter a title for this item:  
  2. Decide where to show the link to this item.
    - On the *Course Menu*, visible on all pages. Link will appear as text.
    -   On an *Organizer Page*:  
      - Link shows item title
      - Link shows icon (select below)
        - Use default icon
        - Use custom icon
- Choose icon:
3. Add this item to your course.

---

